

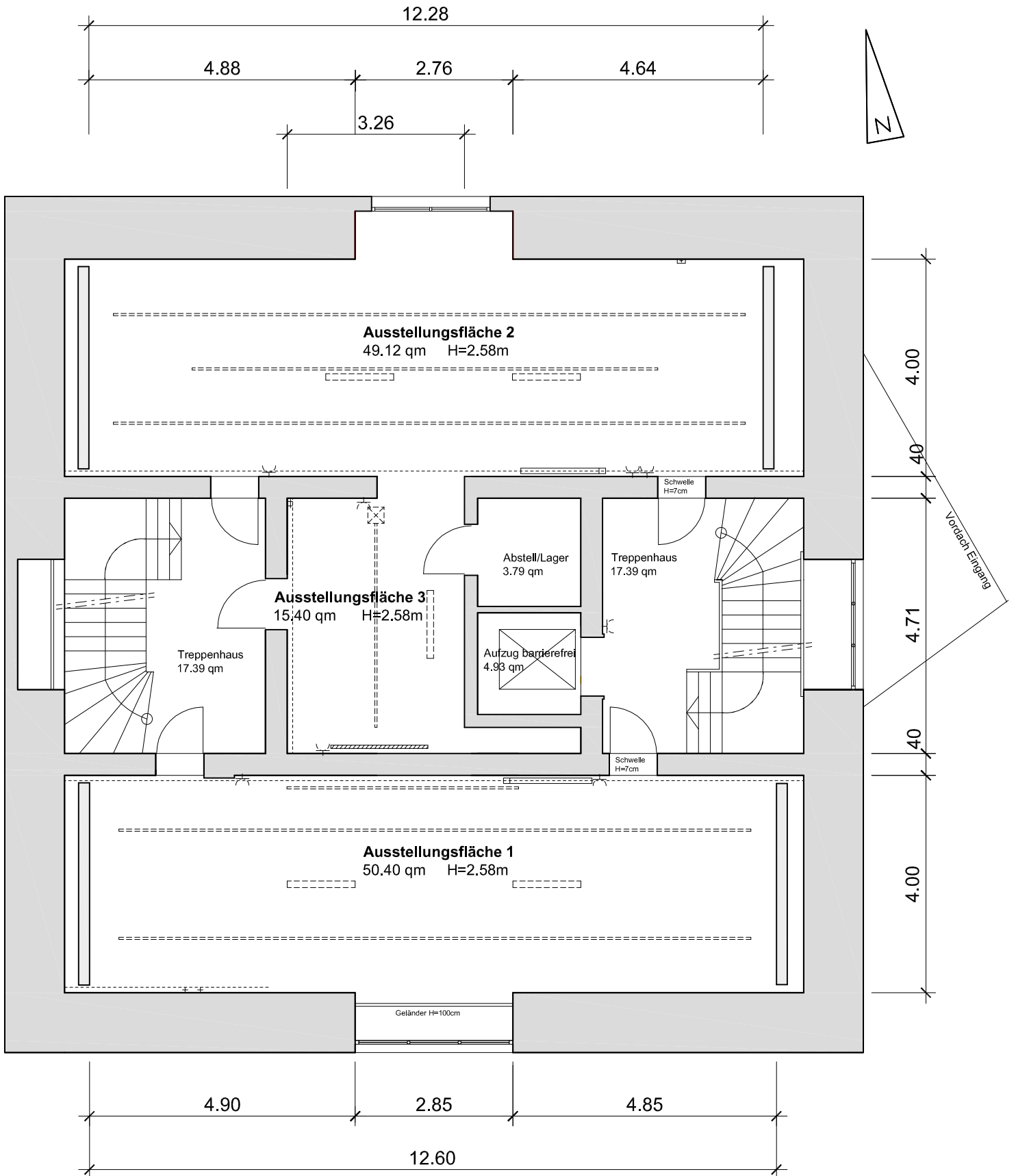





Ausstellungsflächen im Bunker-D - 2.Obergeschoss - M 1:100

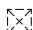
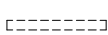
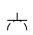
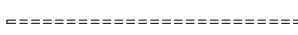
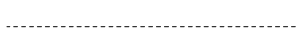
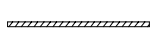

- | | | | |
|---|---|--|--|
|  | Wandfläche mit umlaufender Schattenfuge
H=2,44m B=3,70m |  | Beamer, deckenunterseitig installiert |
|  | Deckenleuchte |  | Steckdose, ~2,20m über OKFB |
|  | Stromschiene mit Strahlern/Spots |  | Heizkörper, bis 80cm über OKFB |
|  | Rohrleitungen horizontal vor der Wand
verlaufend bis 2,33m über OKFB |  | Leinwand B=1,80m, mit je einer
Lautsprecherbox links und rechts |
|  | Rohrleitungen vertikal | | |